

Recessed luminaire - Micro-prismatic diffuser - direct distribution

Sheet steel housing suitable for ceilings with visible T-rails, concealed symmetrical rail constructions and recessed ceilings; Housing colour traffic white RAL 9016; Direct radiant light distribution by means of micro-prism disk made of PMMA, a soft light is emitted on the outside with special ice-finish diffusers; light colour from warm white (927) to daylight white (965) with excellent colour consistency and colour rendering Ra>90; for monitor-based workplaces, 65° < 3000 cd/m<sup>2</sup> all-round anti-glare properties in accordance with the latest standard DIN-EN 12464-1; Integrated DALI LED drivers device type 8 (DT8). Electrical connection via 5-pole connection terminal with plug-in contacts.. TNE-BM mounting mechanism 4 pcs. 600/625 for concealed symmetrical rail constructions or recessed ceilings, please order separately. DALI control units must be ordered separately.

## CHARACTERISTICS

Order number	50802416970
EAN number	4020863367276
Commodity code	94051190
Certification mark	IP 20, Protection class I, VDU 65°<3000, F, F-"roof" mark, Indoor, CE
Impact resistance (IK rating)	IK02
Ambient temperatur	ta 25°C
Special properties	Ready for IoT
Warranty period	5 years

## ELECTRICAL ENGINEERING

Controller	Electronic driver DALI device type 8 (1 pcs.)
System output	46W
Mains voltage	230V/50Hz
Circuit breakers (inrush current)	13 pieces/B10, 22 pieces/B16, 21 pieces/C10, 36 pieces/C16
Energy efficiency class/light source	E

## LIGHTING TECHNOLOGY

Placement	LED, Colour rendering/Light colour CRI ≥ 90 / 2700K-6500K continuously adjustable
Colour tolerance (MacAdam)	3SDCM
Photobiological safety (Luminaire)	RG0
Nominal luminous flux	3950lm
LED service life	50000h L80/B10 (Tq 25°C)
Luminaire luminous efficiency	85lm/W
UGR lat./long.	18.5 / 18.9

## MECHANICS

Housing colour	traffic white RAL 9016
Dimensions (LxWxH/DxH)	622mm x 622mm x 102mm
Depth	100mm
Ceiling system	Ceilings with visible T-rails [s-TS] (625x625 mm), Concealed symmetrical rail construction [VS] (625x625 mm), cut-out ceilings [AD]
Ceiling cut-out (LxW/D)	585mm x 591mm
Installation depth	120mm [AD]; 250mm [s-TS]; 120mm [VS]
Weight (net)	6.25kg
Type of installation	Recessed mounting, Ceiling installation individual mounting

## DEEP-LINK

<https://www.regiolux.de/en/article/50802416970>

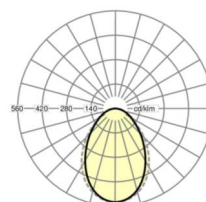

Reference	LED 4000lm 927-965
ηLB	100 %
Φ ↓/↑	100 % / 0 %
UGR lat./long.	18.5 / 18.9
VDU	65° < 3000cd/m <sup>2</sup>

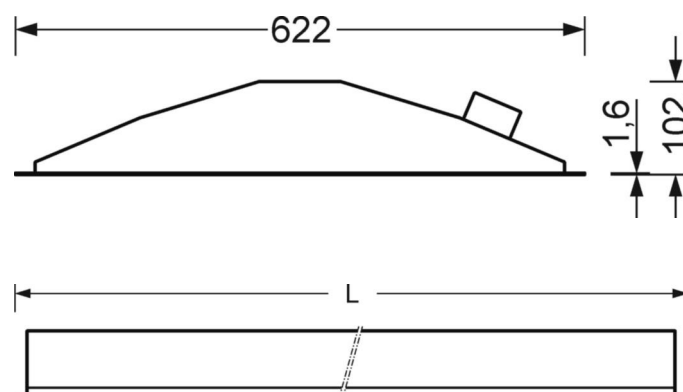

## Dimensions

---

<b>L</b>	622 mm	Length
<b>B</b>	622 mm	Width
<b>H</b>	102 mm	Height
<b>T</b>	100 mm	Depth
<b>DA(L)</b>	585 mm	Cutting dimension length
<b>DA(B)</b>	591 mm	Cutting dimension width
<b>Et(AD)</b>	120 mm	Ceiling distance minimum (cut-out ceiling)
<b>Et(TS)</b>	250 mm	Ceiling distance minimum - recommended (visible T-rail)
<b>Et(VS)</b>	120 mm	Ceiling distance minimum (concealed symmetrical)
<b>MLTS1</b>	625 mm	Module dimension length (visible T-rail)
<b>MLTS_1/2</b>	625	Module dimension length (visible T-rail) 1/2
<b>MLVS</b>	625 mm	Module dimension length (concealed symmetrical)
<b>MBTS1</b>	625 mm	Module dimension width (visible T-rail)
<b>MBTS_1/2</b>	625	Module dimension width (visible T-rail) 1/2
<b>MBVS</b>	625 mm	Module dimension width (concealed symmetrical)

---